

Suggestions:
Cedar Lumber
3" exterior screws

- 2" x 8" x 8' (4)
- 2" x 8" x 4' (4)
- 2" x 4" x 16" (6)
- 2" x 4" x 16" (6)
- 2" x 4" x 48" (1)

BASIC BED BUILDING SEQUENCE

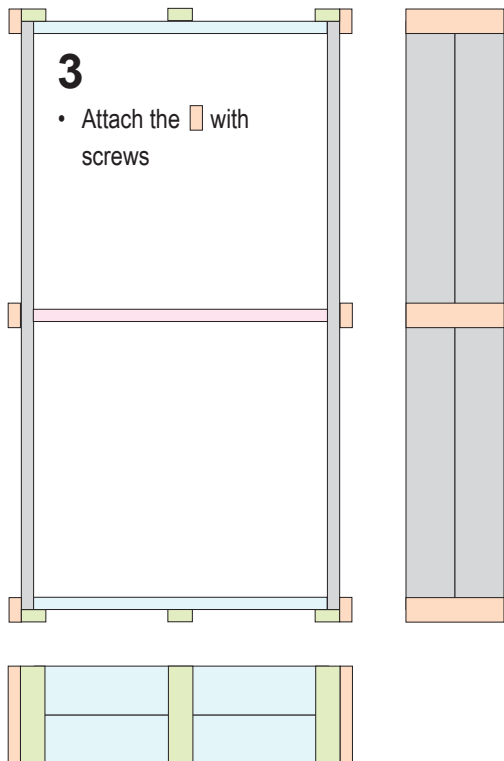
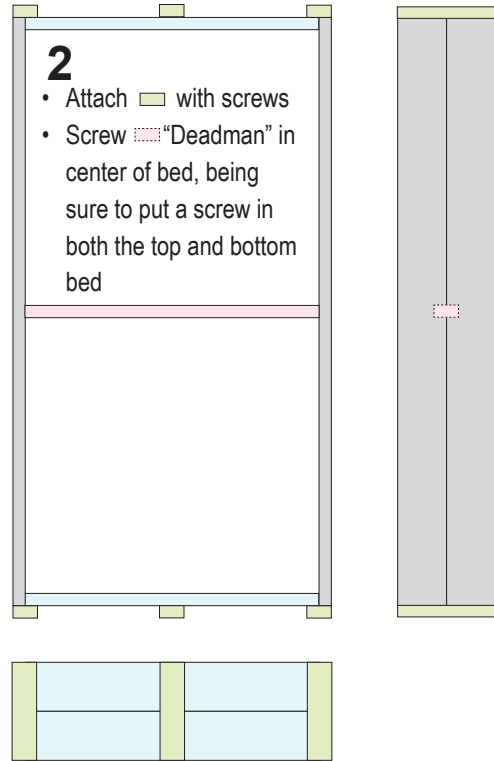
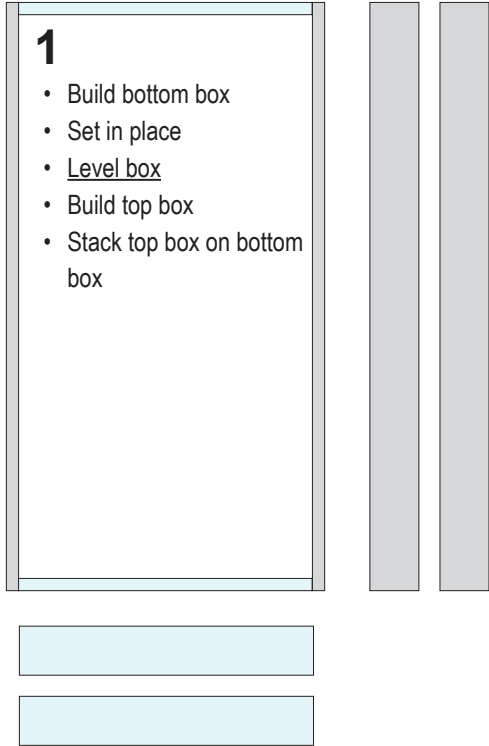

ADD-ON FEATURES

ARCHED TRELLIS

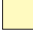
- Build two beds approximately 4' - 5' apart
- Screw 4'  trellis support posts on the ends between the two beds
- Bend Livestock panel and attach to the inside of posts (use small metal pipe straps or large fence staples)
 - Note: we raised the panel about 2" above the ground level to allow for weedeater use.

MATERIALS

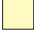
-  2" x 4" x 48" (4) trellis support posts
- 48" - 50" X 16' Welded Livestock panel (1)
- Small metal pipe straps or large fence staples (12 - 16)

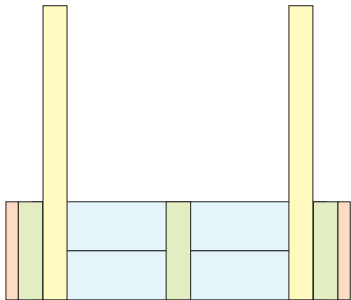
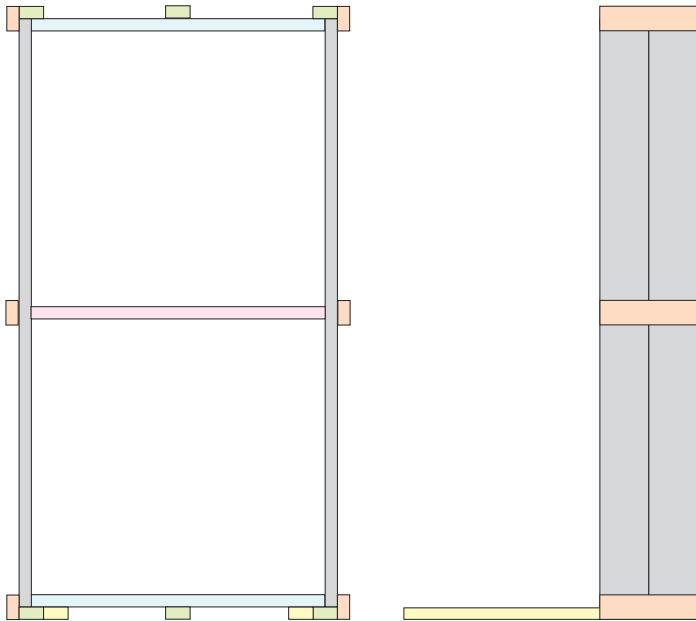

ADD-ON FEATURES

SEAT

- Screw 5" seat supports to top of bed as shown
- Lay 1" x 8" seat material on supports with a 1" - 2" overlap into the inside of the bed.
- Cut seat material to fit bed
- Attach down with screws
- Consider rounding corners for safety

MATERIALS

- 2" x 4" x 5" (9/bed) seat supports
- ▨ *1" x 8" x (10' approx.) (2/bed) seat tops on long sides
- ▨ *1" x 8" x (6' approx.) (1/bed) seat top on end
- 1 1/2" or 2" exterior screws for seat tops
- 2 1/2" exterior screws for seat supports

*Note: do not cut seat tops until bed is finished. Lay seat tops on final bed to determine length needed.

